

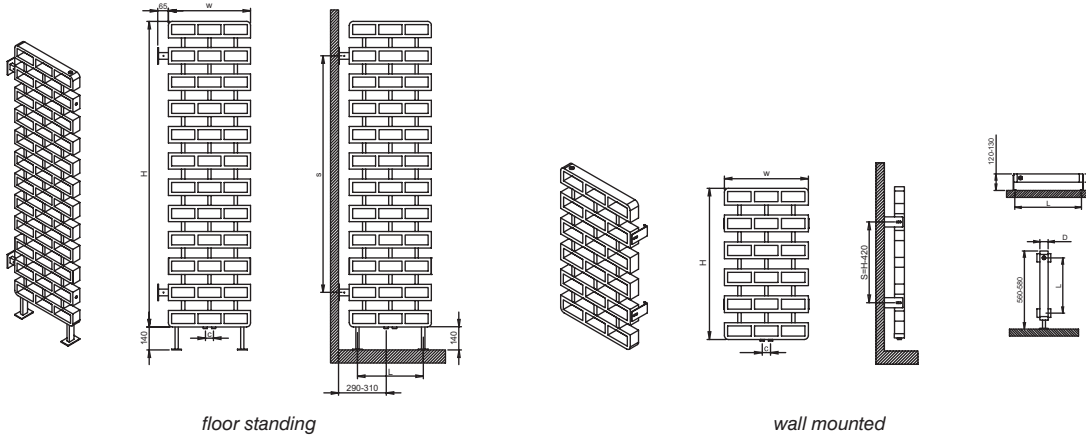

**brico**

floor standing

wall mounted

material	finish	electric version	wall installation	warranty
stainless steel	satın polished	not available	floor standing wall mounted	10 years

max. working pressure: 10 bar  
 max. working temperature: 95°C  
 all dimensions are in mm.  
 connections 1/2"

Product Code	Width	Height	Depth	Connection Centers	Tube Quantity	Assembly Axis		Weight	Water Capacity	THERMAL POWER		
	W	H	D	C		S	L	kg.	lt.	btu	k/cal	watt
BRI050009000609	500	900	60	50	6	480	400	19,2	7,9	1965	495	576
BRI050012200809	500	1220	60	50	8	800	400	24,7	10,5	2639	665	773
BRI050015401009	500	1540	60	50	10	1120	400	29,7	14,9	3313	835	971
BRI050018601209	500	1860	60	50	12	1440	400	34,2	16,5	3972	1001	1164

# BRICO

## DIVERTER

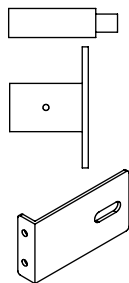
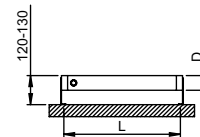
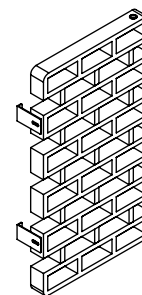
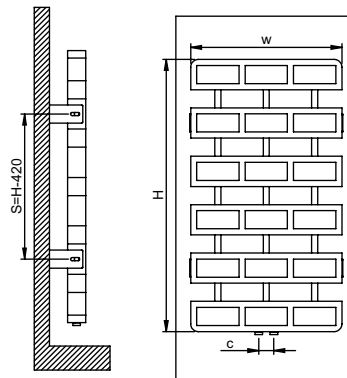
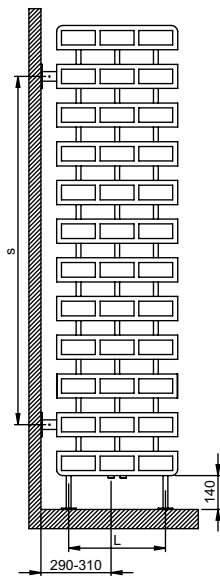
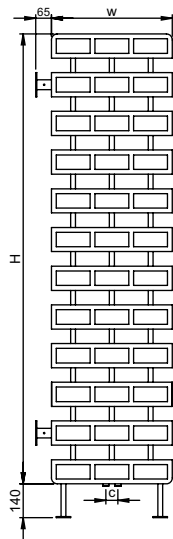
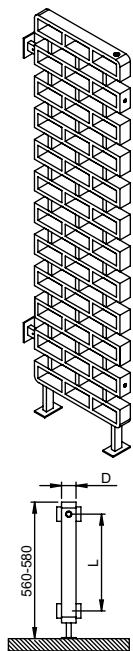

Product Code	Width	Height	Depth	Connection Centers	Tube Quantity	Assembly Axis		Weight	Water Capacity
	W	H	D	C	S	L	kg.	lt.	
BRI050009000609	500	900	60	50	6	480	400	19	8
BRI050012200809	500	1220	60	50	8	800	400	25	11
BRI050015401009	500	1540	60	50	10	1120	400	30	15
BRI050018601209	500	1860	60	50	12	1440	400	34	17