

# Fitting Instruction-Perm S

Code:ym.24.01-00.01

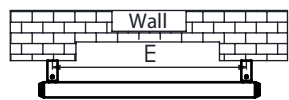
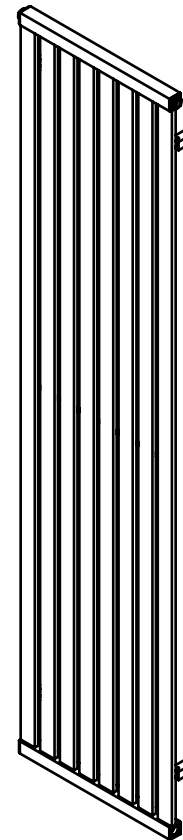
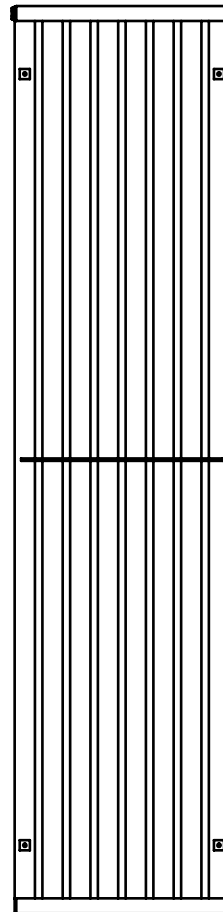
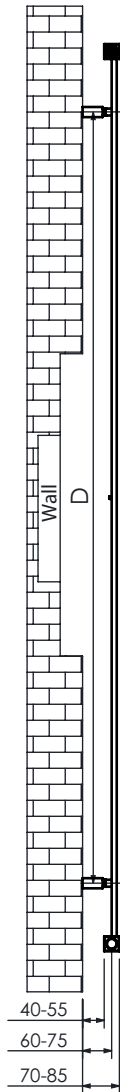
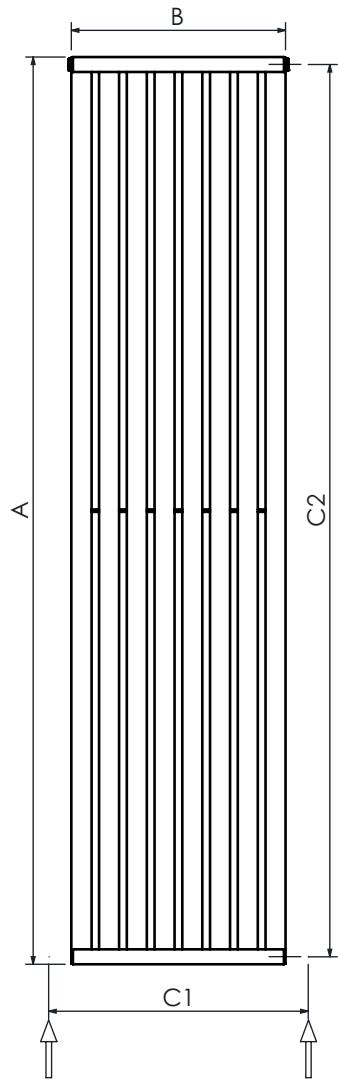

MODEL NAME	A	B	C	D	E	HEAT OUTPUTS (BTU)	HEAT OUTPUTS (WATT)
	HEIGHT mm	LENGTH mm	PIPE CENTER mm	VERTICAL BRACKET CENTERS mm	HORIZONTAL BRACKET CENTERS mm	Delta T:50 °C	Delta T:50 °C
Perm S202	2000	205	295-1970	1730	165	2118	620
Perm S203	2000	315	405-1970	1730	275	3177	930
Perm S204	2000	425	515-1970	1730	385	4235	1240
Perm S182	1800	205	295-1770	1530	165	1899	556
Perm S183	1800	315	405-1770	1530	275	2849	834
Perm S184	1800	425	515-1770	1530	385	3798	1112
Perm S185	1800	545	635-1770	1530	505	5222	1529
Perm S153	1500	315	405-1470	1230	275	2377	696
Perm S154	1500	425	515-1470	1230	385	3170	928
Perm S155	1500	545	635-1470	1230	505	4358	1276
Perm S124	1200	425	515-1170	930	385	2541	744
Perm S125	1200	545	635-1170	930	505	3494	1023
Perm S127	1200	710	800-1170	930	670	4129	1209
Perm S104	1000	425	515-970	730	385	2104	616
Perm S105	1000	545	635-970	730	505	2893	847
Perm S107	1000	710	800-1170	730	670	3419	1001
Perm S63	600	315	405-570	330	265	943	276
Perm S64	600	425	515-570	330	375	1257	368
Perm S65	600	545	635-570	330	495	1728	506
Perm S67	600	710	800-570	330	660	2043	598
Perm S68	600	810	900-570	330	770	2357	690

Bracket Assembly

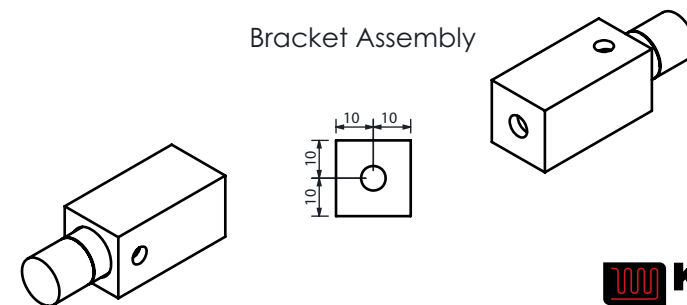

# Fitting Instruction- Perm D

Code:ym.15.07-01

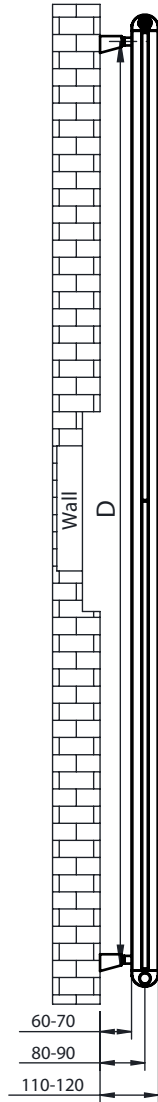
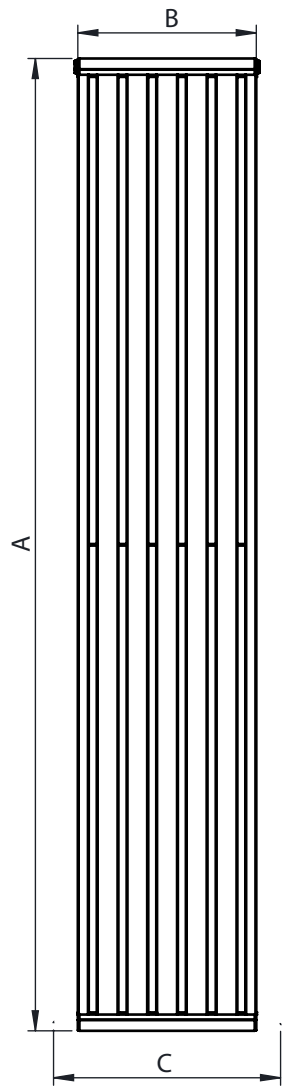

60-70  
80-90  
110-120

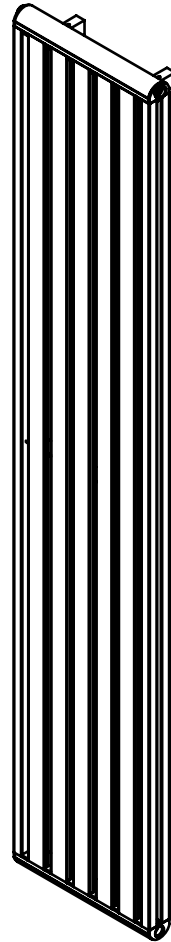

Bracket Assembly

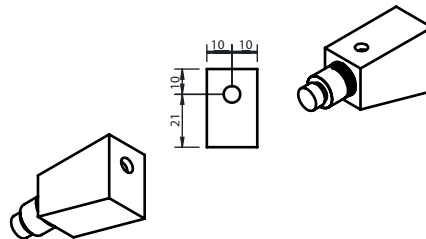
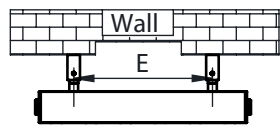

MODEL NAME	A	B	C	D	E	HEAT OUTPUTS (BTU)	HEAT OUTPUTS (WATT)
	HEIGHT mm	LENGTH mm	PIPE CENTER mm	VERTICAL BRAKET CENTERS mm	HORIZONTAL BRACKET CENTERS mm	Delta T:50 °C	Delta T:50 °C
Perm D202	2000	220	310	1900	110	4454	1304
Perm D203	2000	330	420	1900	220	6572	1924
Perm D204	2000	440	530	1900	330	8682	2542
Perm D205	2000	550	640	1900	440	10814	3166
Perm D182	1800	220	310	1700	110	4006	1173
Perm D183	1800	330	420	1700	220	5912	1731
Perm D184	1800	440	530	1700	330	7818	2289
Perm D185	1800	550	640	1700	440	9728	2848
Perm D152	1500	220	310	1400	110	3340	978
Perm D153	1500	330	420	1400	220	4929	1443
Perm D154	1500	440	530	1400	330	6520	1909
Perm D155	1500	550	640	1400	440	8112	2375
Perm D122	1200	220	310	1100	110	2671	782
Perm D123	1200	330	420	1100	220	3945	1155
Perm D124	1200	440	530	1100	330	5216	1527
Perm D125	1200	550	640	1100	440	6490	1900
Perm D126	1200	660	750	1100	550	7760	2272
Perm D103	1000	330	420	900	220	3286	962
Perm D104	1000	440	530	900	330	4348	1273
Perm D105	1000	550	640	900	440	5407	1583
Perm D106	1000	660	750	900	550	6466	1893
Perm D84	800	440	530	700	330	3518	1030
Perm D85	800	550	640	700	440	4375	1281
Perm D86	800	660	750	700	550	5233	1532
Perm D64	600	440	530	500	330	2606	763
Perm D65	600	550	640	500	440	3241	949
Perm D66	600	660	750	500	550	3877	1135
Perm D67	600	770	860	500	660	4512	1321
Perm D45	450	550	640	350	440	2432	712
Perm D46	450	660	750	350	550	2910	852
Perm D47	450	770	860	350	660	3385	991
Perm D48	450	880	970	350	770	3863	1131

# Fitting Instruction- Perm T

Code:ym.25.00-01

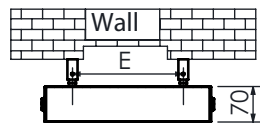
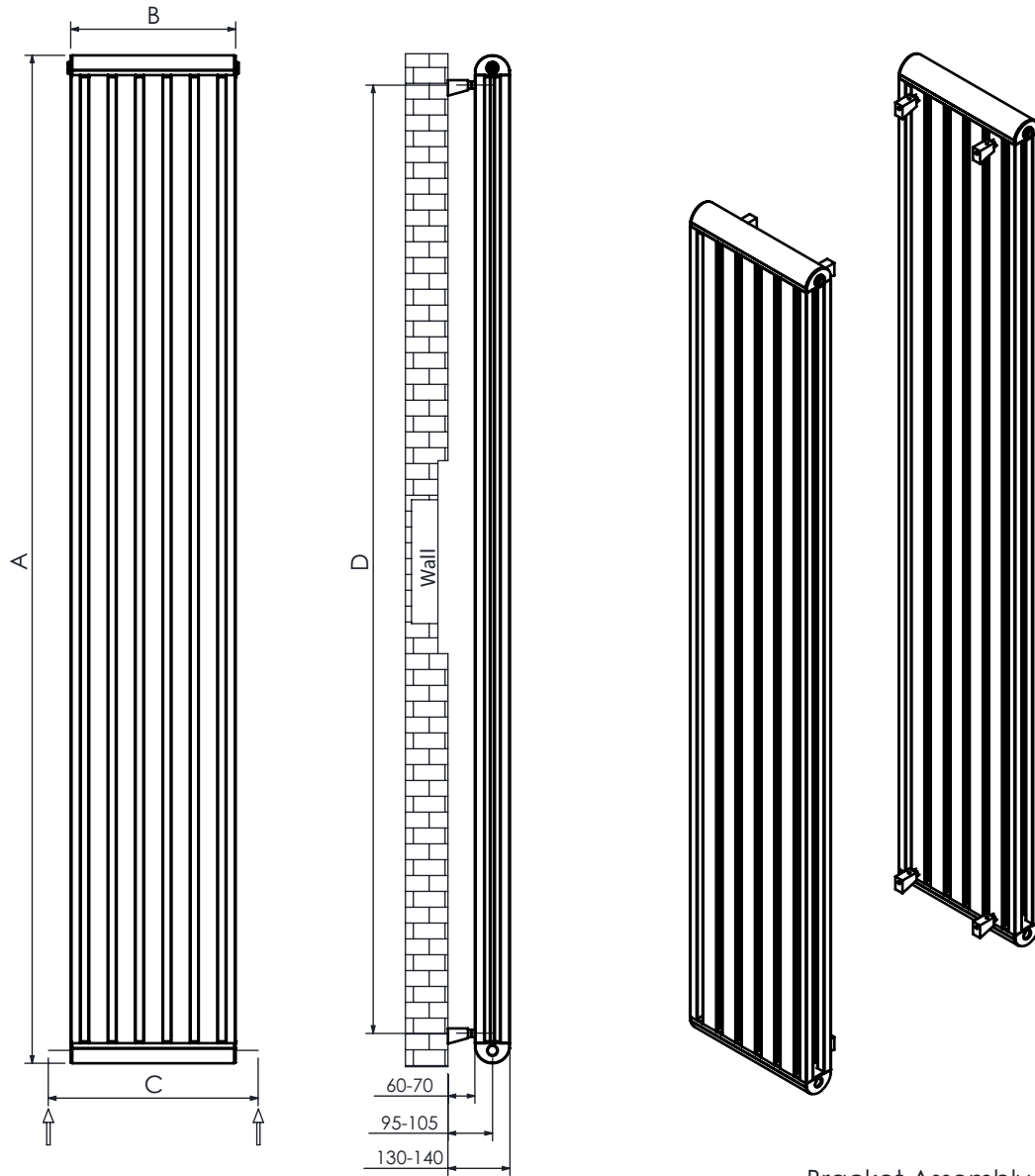

Bracket Assembly

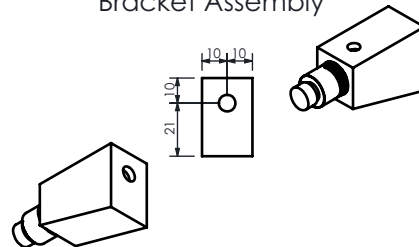

MODEL NAME	A HEIGHT mm	B LENGTH mm	C PIPE CENTER mm	D VERTICAL BRACKET CENTERS mm	E HORIZONTAL BRACKET CENTERS mm	HEAT OUTPUTS (BTU) Delta T:50 °C	HEAT OUTPUTS (WATT) Delta T:50 °C
Perm T202	2020	220	1970-310	1900	110	6681	1956
Perm T203	2020	330	1970-420	1900	220	9857	2886
Perm T204	2020	440	1970-530	1900	330	13024	3813
Perm T205	2020	550	1970-640	1900	440	16221	4749
Perm T182	1820	220	1770-310	1700	110	6010	1760
Perm T183	1820	330	1770-420	1700	220	8869	2597
Perm T184	1820	440	1770-530	1700	330	11727	3434
Perm T185	1820	550	1770-640	1700	440	14591	4272
Perm T152	1520	220	1470-310	1400	110	5011	1467
Perm T153	1520	330	1470-420	1400	220	7393	2165
Perm T154	1520	440	1470-530	1400	330	9781	2864
Perm T155	1520	550	1470-640	1400	440	12168	3563
Perm T122	1220	220	1170-310	1100	110	4006	1173
Perm T123	1220	330	1170-420	1100	220	5918	1733
Perm T124	1220	440	1170-530	1100	330	7823	2291
Perm T125	1220	550	1170-640	1100	440	9734	2850
Perm T126	1220	660	1170-750	1100	550	11640	3408
Perm T103	1020	330	1170-420	900	220	4929	1443
Perm T104	1020	440	970-530	900	330	6522	1910
Perm T105	1020	550	970-640	900	440	8110	2375
Perm T106	1020	660	970-750	900	550	9699	2840
Perm T84	820	440	770-530	700	330	5277	1545
Perm T85	820	550	770-640	700	440	6563	1922
Perm T86	820	660	770-750	700	550	7849	2298
Perm T64	620	440	570-530	500	330	3309	1145
Perm T65	620	550	570-640	500	440	4862	1424
Perm T66	620	660	570-750	500	550	5815	1703
Perm T67	620	770	570-860	500	660	6768	1982
Perm T45	470	550	420-640	350	440	3648	1068
Perm T46	470	660	420-750	350	550	4365	1278
Perm T47	470	770	420-860	350	660	5077	1487
Perm T48	470	880	420-970	350	770	5795	1697