

Vigor

Height: 1300

Width: 580

Depth: 115

Tube \varnothing : 25.4 + 22

Output @ 50°C Δ T: 231 W

Electric element: 100 W

All dimensions in millimetres

Manufactured from ISO/CEN CuZn30As (BS CZ126) brass tube

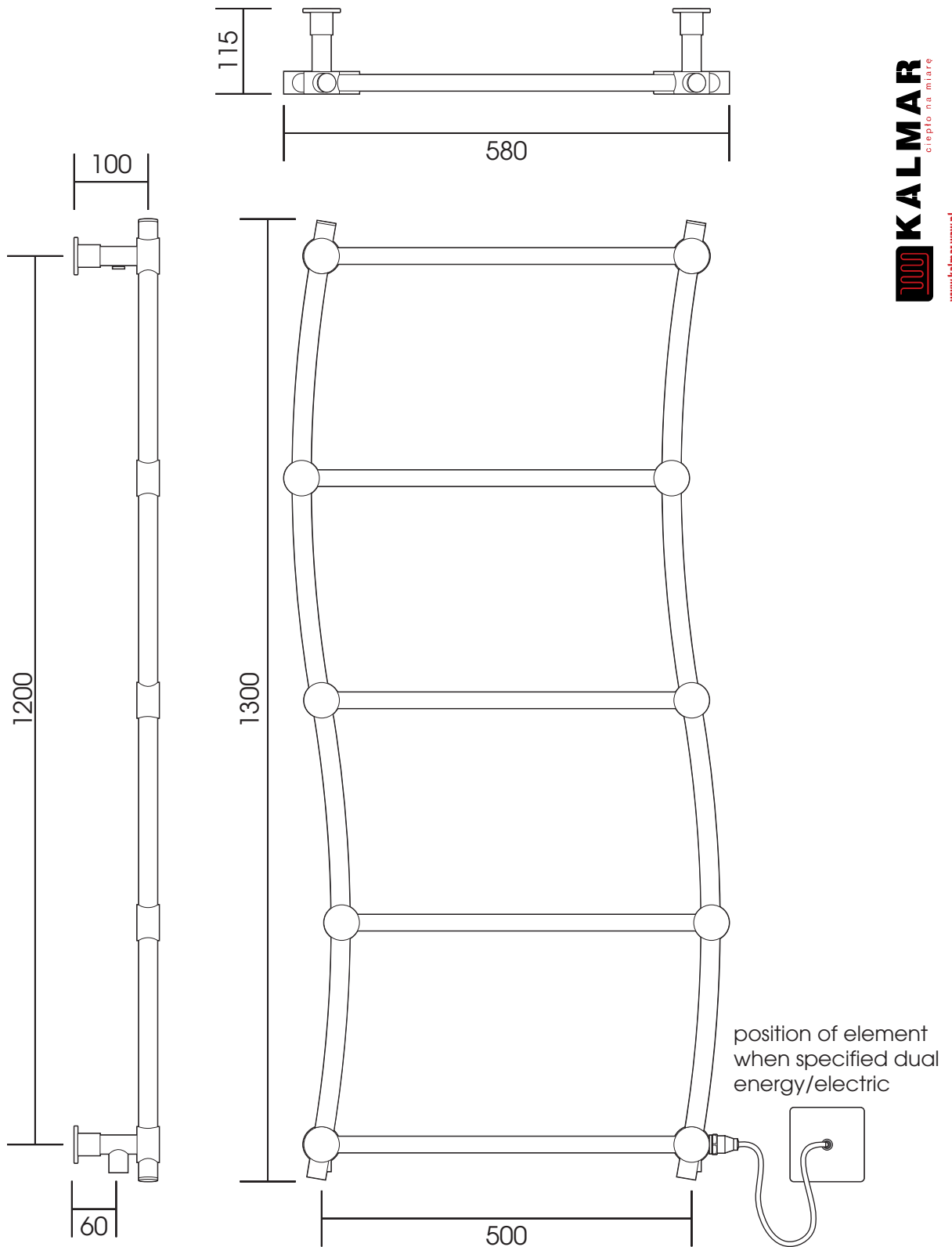

KALMAR
ciepło na miarę
www.kalmar.waw.pl

We reserve the right to alter specifications without prior notice. All measurements given are nominal dimensions only.

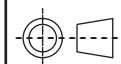

SCALE 1:8