

# Viper

Height: 1200

Width: 400

Depth: 90

Tube : 30 Sq. + 40 Sq.

Output @ 50°CΔT: 421 W

Electric element: 200W

All dimensions in millimetres

Manufactured from 1.4301/X5CrNi18-10 stainless steel

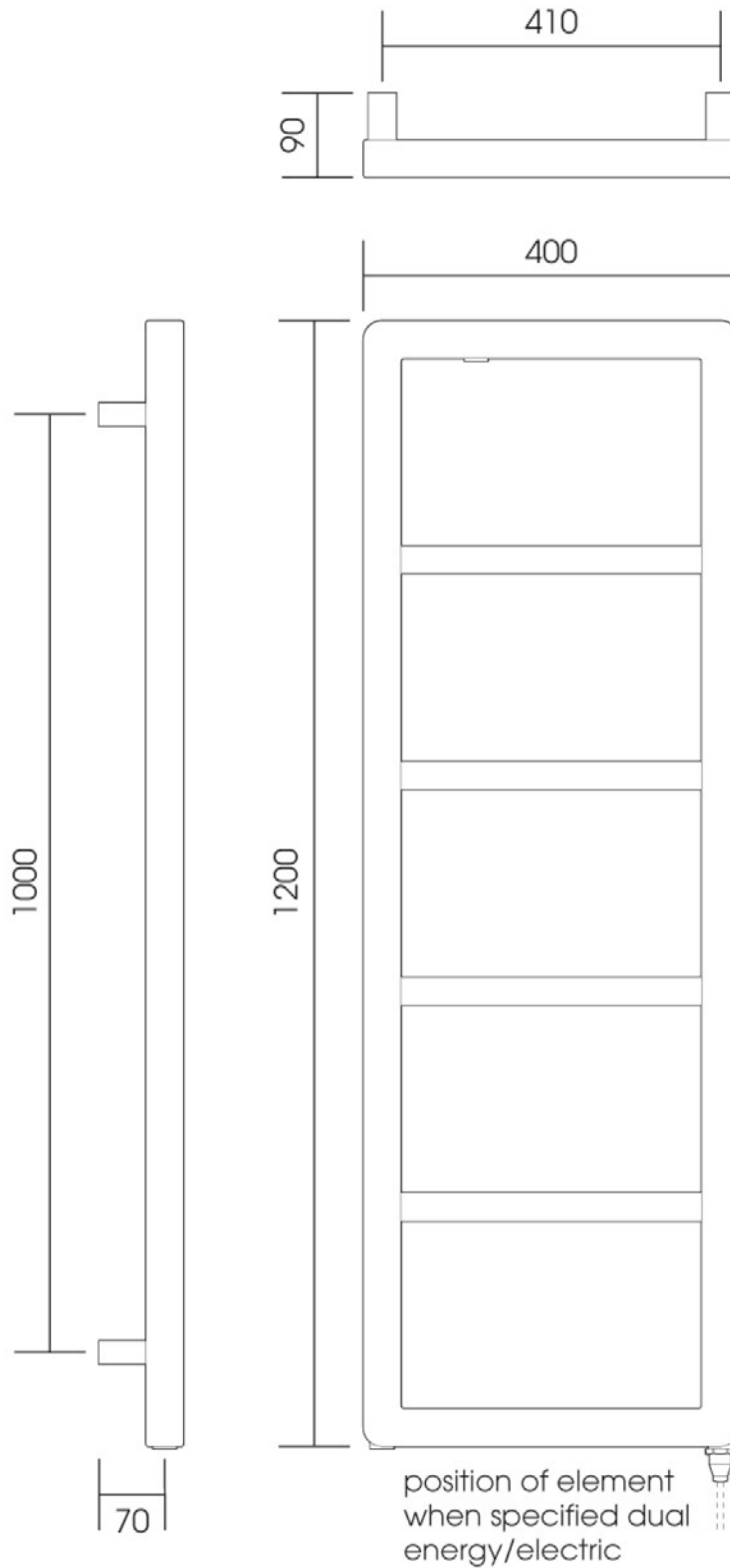

**KALMAR**  
cieplo na miarę

[www.kalmar.waw.pl](http://www.kalmar.waw.pl)

We reserve the right to alter specifications without prior notice.  
All measurements given are nominal dimensions only.

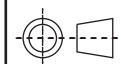

SCALE 1:8